

S7R5584X30-C

30X 8MP Day & Night 30 FPS IR Vandal Resistant PTZ IP Camera

www.meritlilin.com



- ▶ 30X Optical Zoom Lens(4.94 – 148.2mm)
- ▶ 8X Digital Zoom
- ▶ Day & Night (IR cut removable)
- ▶ Ultra HD 8M megapixel CMOS image sensor
- ▶ 8MP H.265/HEVC and H.264/AVC high-performance video compression
- ▶ Simultaneous streaming of H.265 and H.264 encoded streams
- ▶ 3D noise reduction (MCTF)
- ▶ HDR function up to 140dB
- ▶ IVS / AI supported
- ▶ Motion / Tamper / Audio / Alarm / Network lost detection / Global Counter / Virtual Input / Metadata function
- ▶ SMART event
- ▶ 200-metre infrared night vision
- ▶ Defog function
- ▶ Dynamic privacy zone mask
- ▶ Horizontal & Vertical Flip
- ▶ 360° Endless panning
- ▶ Tilting range up to 240°
- ▶ Up to 256 Programmable Preset Positions
- ▶ 2-way audio supported
- ▶ ONVIF Profile S, Profile T and Profile G supported
- ▶ RS-485 supported
- ▶ Weatherproof IP66
- ▶ Vandal resistant approve IK10
- ▶ Rain repellent glass (Optional)
- ▶ NEMA 4X certified

Dimensions

395 (H) × 198 (D) mm

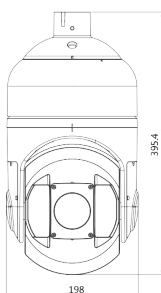
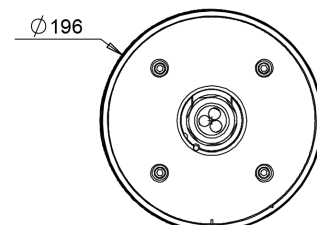

Diagram of mounting holes:(unit in mm)



30X Optical Zoom

Remote pan/tilt/zoom operations with 30X optical lens makes it possible to zoom in on distant object with absolute clarity



Wind and Rain Standards

Meet international IP66 standards for dust and moisture resistant allowing you to install cameras in environments subject to wind and rain



Impact Resistant

IK10-certified housing designed to protect the camera from destructive behavior



Two-way Audio Support

With 2-way audio communication, you can project your voice through the camera's speaker instead of hearing what's going on (1-way audio)



Day and Night Operations via Removal of the IR-cut filter

S7R5584X30-C camera was designed using a mechanical IR cut filter for increased IR sensitivity resulting in improved night time images. The removable IR-cut filter allows day and night operations even in the low lux condition providing outstanding vision



Sense Up+

Deliver outstanding video outputs in poor light conditions without experiencing motion blur. You can see video clearly even during nighttime without sufficient lighting support



3D Noise Reduction

Remove noise from a signal. Suppressing noise in an image in low light conditions and able to retain quality videos at the same time



High Dynamic Range

An High Dynamic Range (HDR) image is made by taking 3 frames of the same scene and each at different shutter speeds to display details of both the darkest and brightest areas. HDR can extend image visibility under high contrast lighting scenes and improve image quality



Privacy Masking

Privacy Masking is a feature used to protect personal privacy by concealing private areas in the camera's field of view. Doorways and house windows for example are not subject to surveillance



Video Security App

Available on Android and iOS – LILIN Pro app provides security alarm push notification, real-time live viewing, and remote video playback



30X 8MP Day & Night 30 FPS IR Vandal Resistant PTZ IP Camera

| Video Performance | |
|-------------------|--------------------------------------------------------------------------------------------------------------------------------------------------------------------------------------------------------------------------------------------------------------------------------------------------------------------------------------|
| Model | S7R5584X30-C |
| Min. Illumination | 0.02 lux (1/30 sec, F1.6(Wide), 30IRE, AGC-Gain: 60dB ICR-OFF Color mode) 0.005 lux (1/30 sec, F1.6(Wide), 30IRE, AGC-Gain: 60dB ICR-ON B/W mode) 0.004 lux (1/8 sec, F1.3(Wide), 30IRE, AGC-Gain: 60dB ICR-OFF Color mode) 0.0005 lux (1/8 sec, F1.3(Wide), 30IRE, AGC-Gain: 60dB ICR-ON B/W mode) 0 Lux with IR LED ON |

| Lens / Night vision (infrared LED) | |
|------------------------------------|--------------------------------------------------------------------------------|
| Lens zoom ratio | 30X Optical |
| Focal Length | 4.94 (WIDE) – 148.2 (TELE) mm |
| Minimum Aperture Ratio | F1.3(Wide) – F4.8(Tele) |
| Iris Range | F1.3 – 32 , Close |
| Iris Control | DC IRIS , ALC (Adjustable Output Target Level) / Manual |
| Minimum Object Distance | 10cm (WIDE end), 1.5M (TELE end) |
| Angle of View | 59.8°(W) – 2.1°(T) (H) 34.8°(W) – 1.2°(T) (V) 63.1°(W) – 2.5°(T) (D) |
| Zoom Speed | 0 – 7 Selectable [Fast : Approx. 6.0 Second (Tele to Wide) in Manual Mode] |
| Focus Speed | 0 – 7 Selectable |
| Focus | Auto (Continue / Interval / Zoom Trigger / One Push), Manual Focus |
| Peak Wavelength | 850nm |
| Beam Spread | Automatically adjusted, Depending on the zoom ratio |
| Radiant Distance | 200M |

| Sensor | |
|------------------|------------------------------------------|
| Pick Up Element | 1/2.8" CMOS image sensor |
| Effective Pixels | 3864 (H) × 2192 (V) = 8,469,888 (Pixels) |

| Certifications | |
|-------------------------|------------------|
| CE | Yes, EMI Class A |
| FCC | Yes, EMI Class A |
| IP Rating | IP66 |
| Vandal Resistant Rating | IK10 (Housing) |
| Nema 4X | Yes |
| UL | Yes UL 62368-1 |

| Pan & Tilt | |
|------------------|--------------------------------------------------------------------------------------------------|
| Control Function | Pan and Tilt / Zoom and Focus / Iris and ICR / 256 Preset Position / Home Position |
| Auto Mode | OFF / SCAN(16) / SEQ(256) / TOUR(16) / PATROL(16) / Auto TRACKING |
| Schedule Setting | OFF / SCAN (4) / SEQ(256) / TOUR(4) / PATROL(4) / Preset Position(256)(via web interface) |
| Panning range | 360° Endless |
| Panning mode | Manual , Auto , Manual Position , Sequential Position |
| Panning speed | Manual Approx. 0.1°/s – 120°/s 8 Steps, Preset Approx. 1°/s – 300°/s, Alarm Trigger Speed 300°/s |
| Tilting range | -30° – +210° |
| Tilting mode | Manual , Auto , Manual Position , Sequential Position |
| Tilting speed | Manual Approx. 0.1°/s – 120°/s 8 Steps, Preset Approx. 1°/s – 300°/s, Alarm Trigger Speed 300°/s |

| PC Requirements | |
|-----------------|------------------------------------------|
| CPU | Intel® Core™ i7 or higher grade |
| OS | Windows 7 or above |
| RAM | 8GB or above, Dedicated Graphics Card |
| Web browser | Microsoft® Internet Explorer® 9 or above |

| Input / Output | |
|----------------------|---------------------------------------------------------------------------------------------------------------------------|
| Audio Input / Output | one audio input / one audio output Terminal block type (microphone not built-in) |
| Live Video Output | CVBS 1.0Vp-p, 75 ohm, BNC connector |
| Audio | Two-way Audio, G.711 u-law / PCM / AAC, External Microphone Required |
| Alarm Input / Output | Digital 4 Input (TTL 5Vdc) , 2 Output (MOS Relay contact N.O., Load.max. 40VDC,450mW / 300mA,450mW) , Terminal block type |

| Video Streaming | |
|-------------------|-------------------------------------------------------------------------------------------------------------------------|
| Video Compression | H.265/HEVC main profile, H.264 main and high profile , Motion JPEG |
| Video Streaming | RTP/HTTP, RTP/TCP, RTP/UDP, Multicast streams in H.265 and H.264 and Motion JPEG, configurable frame rate and bandwidth |
| Video Bitrate | 128Kbps – 12Mbps; Frame rate and bit rate controllable on-the-fly; VBR / CBR / GOP supported, Fixed bitrate, |

| Network Security | |
|------------------|-----------------------------------------------------------------|
| Authentication | Digest HTTP authentication, RTSP authentication, DDNS via HTTPS |
| Address Filter | Yes |
| Access | Multiple user access levels with password protection |
| Users | 10 simultaneous users |
| Multi IP address | Yes |

| Video Resolutions (H x V) | |
|---------------------------|----------------------------------------------------------------------------------------------------------------------------------------------------------------------------------------------------------------------------|
| Resolution | 4K(3840 × 2160), 6M(3072 × 2048), 5MP(2592 × 1944), 4MP(2304 × 1728), 3.1MP(2048 × 1536), 3MP(2304 × 1296), 2MP(1920 × 1080), 1.3MP(1280 × 960), 1MP(1280 × 720), D1(720 × 480, 720 × 576), VGA(640 × 480), CIF(352 × 240) |
| Maximum Frame Rate | Normal mode: 60Hz: 30 FPS @ 3840 × 2160 50Hz: 25 FPS @ 3840 × 2160 HDR mode: 60Hz: 30 FPS @ 3840 × 2160 50Hz: 25 FPS @ 3840 × 2160 |

| Video Functions | |
|---------------------|-----------------------------------------------------------------------------------------|
| Scanning System | Progressive Scan |
| Infrared Cut Filter | Auto / Day (Color) / Night (Mono) / Schedule |
| White Balance | Auto / Manual |
| Electrical Shutter | 1/30(1/25)s – 1/20000s |
| Exposure Mode | AUTO / SHUT.P / IRIS.P |
| Sense Up | Off / x2 / x4 / x8 |
| Sense Up+ | Yes |
| Auto Gain Control | 60 dB Variable Gain |
| S/N Ratio | More than 50dB (AGC off) |
| 3D Noise Reduction | Off / ON(1 – 32) |
| High Dynamic Range | Up to 140dB (by HDR mode, 2 shutter line interleave) |
| Privacy Masking | OFF / ON (Up to 16 area) |
| Image Effects | Brightness, Contrast, Hue, Saturation, Sharpness, Mirror, Flip, Defog, Digital Zoom(x8) |

| Integration | |
|-------------------------|-----------------------------------------------------------------------------------------------------------------------------------------------------------------------------------------------------------------|
| Mobile Application | Integrated to LILIN mobile app (LILIN Pro) iPhone, iPad, Android support |
| Video Management | ONVIF Profile S / ONVIF Profile T / ONVIF Profile G / IVS events, LILIN Navigator Enterprise 5.0 support, Third party VMS through LILIN HTTP API |
| SD Card Recording | Support (128GB) Micro SD/SDHC/SDXC card for circular recording (card is not included) |
| SD Card Compatible List | Micron - 32GB,64GB,128GB,256GB,512GB, 1TB (SDXC, U1, C10) Transcend - 4GB SD,8GB SDHC,32GB SDHC C10,128GB SDXC C10 SanDisk - 8GB SDHC, 32GB, 64GB, 128GB SDHC C10 Kingston - 64GB SDXC C10 |
| Maintenance | Firmware update via HTTP and IP Scan; Firmware available at website |
| IVS Basic 1.0 | Motion / Tamper |
| Event Triggers | Motion / Tamper / Audio / Alarm / Network lost detection / Global Counter / Virtual Input / Metadata |
| Event actions | FTP / SMTP / HTTP post / SD card / SAMBA / Alarm Output / Push Service / Global Counter / Virtual Input |
| Control Interface | RS-485, Half-Duplex, support MLP2, Pelco D/P protocols |
| Languages | English, Traditional Chinese, Simplified Chinese, Spanish, Italian, Turkish, Russian, Korean, French, Arabic, Hungarian, Japanese |

| Network | |
|---------------------|------------------------------------------------------------------------------------------------------------------------------------------------------|
| Ethernet | 10/100/1000 Mbps Base-T, RJ-45 |
| ePTZ & Digital Zoom | - / Yes (X8) |
| Web PTZ control | Pan , tilt , zoom in / out , absolute position, and video-click-n-move |
| OSD | Position configurable text overlay for date, time, camera ID, event status/ Current PTZ Position/ Preset Name, Auto-Pan |
| CPU, Memory | Embedded Quad-core ARM Cortex-A53 1.0GHz CPU & 2GB LPDDR4X, 8GB e.MMC memory |
| OS | Embedded Linux 4.9.84 |
| Network Protocols | IPv4, TCP, UDP, HTTP, HTTPS, QoS, NTP, DDNS, FTP, ARP, DHCP, PPPoE, DNS, RTSP, RTCP, Telnet, ICMP, ONVIF Profile S, ONVIF Profile T, ONVIF Profile G |
| Network Storage | NAS (Support SAMBA/CIFS) |
| User accounts | 10 user accounts available |
| Video Display | LILIN Universal ActiveX & HTML5 |

| Power and Environment | |
|-----------------------|----------------------------------------------------------------------------------------------------------------------------------------|
| Starting Temperature | - 40°C – + 50°C (-40°F – 122°F) |
| Operating Temperature | - 40°C – + 50°C (-40°F – 122°F) |
| Storage Temperature | - 20°C – + 60°C (-4°F – 160°F) |
| Humidity | 0% – 90% |
| Power Supply | AC24V ±10% |
| Power Consumption | AC24V, 32 W (Heater OFF, IR OFF) AC24V, 53 W (Heater OFF, IR ON) AC24V, 73 W (Heater ON, IROFF) AC24V, 90 W (Heater ON, IRON) |

| Mechanical | |
|-----------------|-----------------------------------------------------------|
| Dimension | 395 (H) × 198 (D) mm |
| Weight | 6950 g |
| Casing Material | Aluminum alloy |
| Window | Ø55 Heat Resistant Glass & Rain repellent glass(Optional) |

| Warranty | |
|----------|----------------------------------------------------|
| Warranty | 3 years, but lens and motors are limited in 1 year |

Copyright © Merit LILIN 2021 | All rights reserved | Product specifications and availability are subject to change without notice