



Warning: Do not throw your product in municipal waste. This product has been designed to enable proper reuse of parts and recycling. The symbol of the crossed out wheeled bin indicates that the product (electrical and electronic equipment) should not be placed in municipal waste. Check local regulation for disposal of electronics products.

Installation Guide

66-6832CSB-3

Features

- Standalone Embedded Linux System
- Supports 4K (UHD) IP Cameras
- 4K HDMI Output
- Compatible with iOS and Android devices
- Metadata can be embedded into videos
- Supports Setup Wizard
- HTML5 streaming, multiple browser supported
- P2P easy remote access supported

Product Overview

Internal Hard Drives Model Front View

- ① HDD LED, green, blinking, HDD activity indicator
- ② ALARM LED, red, blinking, alarm status indicator
- ③ LAN LED, green, blinking, network activity indicator
- ④ Power LED, amber, lit constantly, power status indicator
- ⑤ OLED display, system activity information
- ⑥ USB port

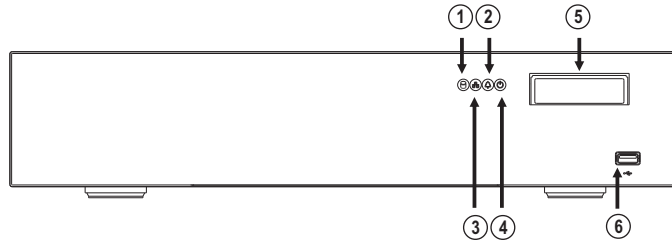

Profession 2U 19" 32ch(64ch)/16port PoE Model Rear View

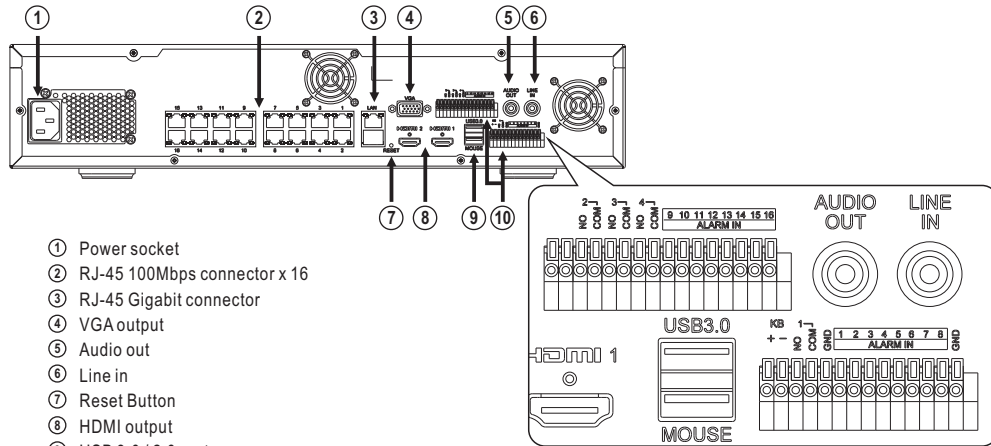

- ① Power socket
- ② RJ-45 100Mbps connector x 16
- ③ RJ-45 Gigabit connector
- ④ VGA output
- ⑤ Audio out
- ⑥ Line in
- ⑦ Reset Button
- ⑧ HDMI output
- ⑨ USB 3.0 / 2.0 port
- ⑩ DI/DO, RS-485, KB

Installation Instructions

Hard drives installation

Profession 2U 19" Internal Hard Drives Model

Remove NVR upper casing and loosen the screws at both sides of the hard drive bracket to take it out, install hard drives and tighten the hard drive with screws as instructed in the image above, and properly connect the SATA and power cables to the connectors, finally, complete the hard drive installation by closing NVR upper casing and tightening the screws.

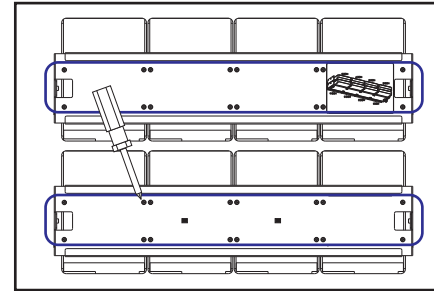
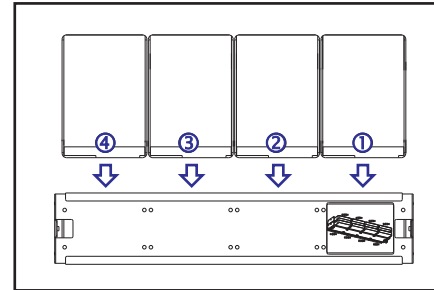

Network Video Recorder Instructions

Please refer to below structure diagram for installation.

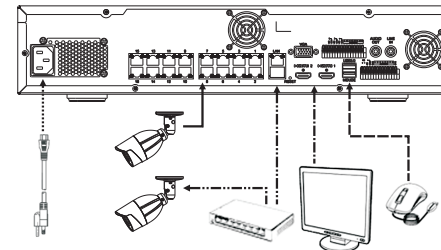

- : Power cord to NVR power socket.
- : USB mouse to NVR USB port.
- : NVR video output (HDMI / VGA) to monitor input.
- : NVR / IP camera ethernet connector to network switch.
- : NVR PoE port to IP camera PoE port.

1. Plug USB mouse into NVR USB port.
2. Plug power cord into NVR power socket.
3. Connect network switch, plug a network cable on NVR RJ-45 Gigabit connector, opposite end of cable into network switch.
4. PoE Series NVR use with PoE IP camera, plug a network cable on NVR RJ-45 PoE 100Mbps connector, opposite end of cable into IP camera
5. NVR use with DC power supply IP camera, plug a network cable on IP camera, opposite end of cable into network switch.
6. Plug HDMI or VGA cable on NVR, opposite end of cable into monitor HDMI or VGA input.
7. Make sure all cables properly connected, power on the NVR.

All information, trademarks, logos, graphics, and other items appearing on this manual ("Information") are for reference only and is subject to change at any time without prior notice. Whilst we endeavor to ensure the accuracy of the Information on this manual, no express or implied warranty is given by us to the accuracy of the Information. We shall bear no responsibility for any incorrectness or leakage.

Begin using the NVR

For details about NVR operation, please scan the QR code inside the package to get the operation manual.

Emergency Factory Default

To restore the hardware to factory default settings, please follow these steps:

1. Open the Menu, [Setup -> System -> Maintenance] then select the [Hardware Reset] to ON to enable.
2. Press and hold "RESET Key" for 10 seconds and release.
3. The NVR will be restored to factory default settings after approximately 40 seconds and will reboot automatically.

NOTE1: The factory default username and password are empty, and the user can set an account for login.

NOTE2: The IP address will revert to the default setting of 192.168.0.111.

Login

The factory default username and password are empty. To login to the NVR, please set the username and password on the login page. Press [Login] to complete the setting and login simultaneously.

Password have to meet the following criteria:

1. More than or equal to 8 characters.
2. Allow uppercase letter, lowercase letter, number digit, and special character.
3. Must have at least three types of character sets.

Caution

- Do not drop or strike the equipment.
- Do not install the equipment near naked flames or heat sources.
- Do not expose this unit to rain, moisture, smoke or dusty environments.
- Do not cover the opening of the unit with cloth or plastic or install this unit in a poorly-ventilated place. Allow 10 cm between this unit and its surroundings.
- Do not continue to operate the unit under abnormal conditions such as detection of smoke, strange smell, or malfunctioned screen whilst power is turned on.
- Do not touch the power connection with wet hands.
- Do not damage the power cord or leave it under pressure.
- To avoid unnecessary magnetic interference, do not operate this unit near magnets, speaker system, etc.
- All connection cables must be grounded properly.

CAUTION

RISK OF EXPLOSION IF BATTERY IS REPLACED WITH AN INCORRECT TYPE DISPOSE OF USED BATTERIES ACCORDING TO THE INSTRUCTIONS

警告：此圖示，指在廢棄產品時不可直接丟棄垃圾桶，應進行拆解，並分類進行回收再利用。



安裝說明

產品特色

- 嵌入式 Linux 系統
- 支援 4K 超高清網路攝影機
- 4K HDMI 輸出
- 支援 IOS 以及 Android (安卓) 系統裝置
- 外部描述資料 (METADATA) 的記錄及影像結合
- 設定精靈，快速完成攝影機及系統設定
- HTML5 串流支援，無需安裝任何元件，多種瀏覽器直接檢視
- P2P 簡易遠端瀏覽

部件說明及尺寸

內接式硬碟機種前面板說明

- ① 硬碟指示LED，綠色、閃爍，顯示硬碟存取
- ② 警報指示LED，紅色、閃爍，顯示警報是否觸發
- ③ 網路指示LED，綠色、閃爍，顯示網路是否連接
- ④ 電源指示LED，橘色、長亮，顯示電源狀態
- ⑤ OLED 顯示器，各種系統資訊顯示
- ⑥ USB 埠

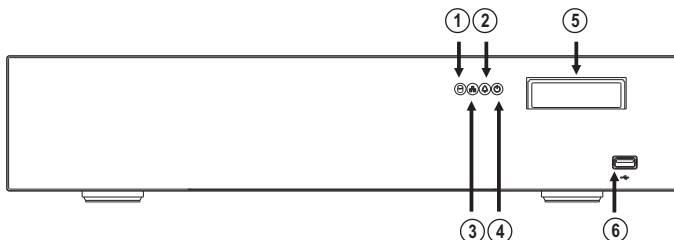

專業型2U 19吋 32ch(64ch)/16port PoE機種後背板說明

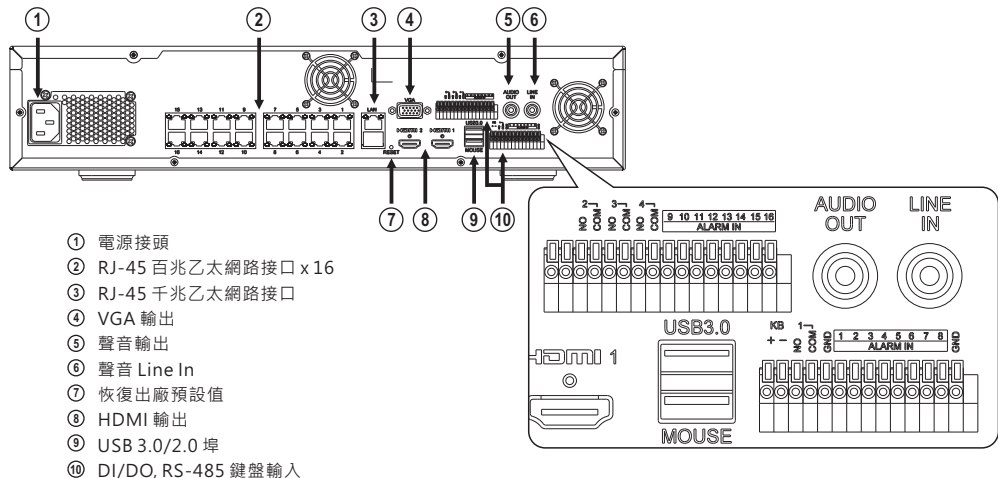

- ① 電源接頭
- ② RJ-45 百兆乙太網路接口 x 16
- ③ RJ-45 千兆乙太網路接口
- ④ VGA 輸出
- ⑤ 聲音輸出
- ⑥ 聲音 Line In
- ⑦ 恢復出廠預設值
- ⑧ HDMI 輸出
- ⑨ USB 3.0/2.0 埠
- ⑩ DI/DO, RS-485 鍵盤輸入

安裝說明

硬碟安裝說明

專業型 2U 19 吋內接式硬碟機種

卸除螺絲並移除主機機殼上蓋，卸除兩側鎖點螺絲取下硬碟安裝支架，使用配件包中螺絲將硬碟固定於硬碟支架上，將硬碟支架置回，鎖緊硬碟支架兩側鎖點固定硬碟支架，將硬碟接上 SATA 線及電源線。

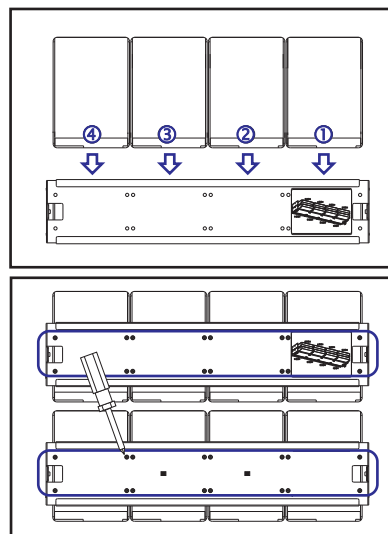

網路錄放影機連接說明

參考下列架構連接錄放影機

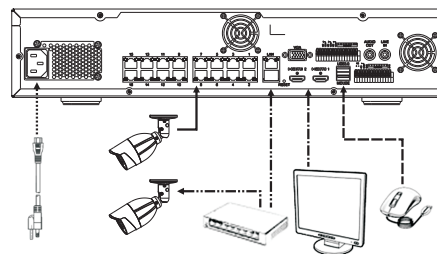

- : 電源線 至 NVR 電源接頭
- : USB 滑鼠 至 NVR USB 滑鼠連接埠
- : NVR 影像輸出 (HDMI / VGA) 至 螢幕輸入
- : NVR / 網路攝影機乙太網路接口 至 網路交換機
- : NVR PoE 輸出至網路攝影機 PoE 輸入

1. 將 USB 滑鼠插入網路錄影機的 USB 滑鼠連接埠
2. 將電源線接入網路錄影機的電源接頭
3. 使用 RJ-45 網路線，將一端接在網路錄影機的乙太網路接口，另一端接入安裝環境中的網路交換器
4. 如使用 PoE 網路錄影機系列搭配 PoE 網路攝影機，使用 RJ-45 網路線，將一端接在網路錄影機的 PoE 乙太網路接口，另一端接在網路攝影機的 PoE 乙太網路接口
5. 如使用直流供電攝影機，使用 RJ-45 網路線，將一端接在網路攝影機的乙太網路接口，另一端接入安裝環境中的網路交換機
6. 使用 HDMI 或 VGA 連接線，將一端接入網路錄影機的 HDMI 或 VGA 輸出埠，另一端接入螢幕的輸入埠
7. 確認上述項目都已妥善連接後開啟網路錄影機電源

開始使用4K超高清網路錄放影機

關於錄放影機的使用請掃描包裝中所附 QR 圖碼 (QR Code)，取得完整的說明。

回復出廠預設值

- 使用硬體來回復出廠預設值，請按照下列步驟：
1. 開啟選單 [設定 -> 系統設定 -> 維護] 選擇 [硬體重置 ON] 啟用。
 2. 按住「回復出廠預設值按鍵」10 秒鐘。
 3. 約40秒鐘後網路錄放影機將重新開機。

註1：出廠預設的使用者名稱和密碼為空白，由使用者自行設定輸入。

註2：為方便使用者起見，回復出廠預設值會回復到預設 IP 位址 192.168.0.111。

登入

出廠預設的使用者名稱和密碼為空白。欲登入網路錄放影機，請在登入頁面，設定使用者名稱及密碼並按下確認鍵，可同時完成使用者設定並登入。

密碼強度要求：

1. 密碼長度需要8個字以上。
2. 密碼必須包含英文字大寫、小寫、數字及特殊符號。
3. 密碼必須強制使用至少3種文字型態。

注意事項

- 請勿摔落或敲打設備
- 請勿將設備安裝於火源或熱源附近
- 請勿將設備暴露於雨水、高濕度、煙霧、及高落塵的環境中
- 請勿將設備換氣孔以衣物或任何物品遮蔽，或將設備安裝於通風不良的環境中，請在設備周圍保留 10 公分的間隙
- 請立即關閉設備電源當發現有煙霧、異味、螢幕無訊號及其他異常狀況
- 操作時請保持乾燥
- 請勿凹折或重壓電源線
- 請勿將設備置遠離高磁性物體，避免不必要的干擾，如磁鐵、或高功率喇叭等等
- 請將所有連接線材妥善接地

注意

若使用錯誤的電池會有爆炸的危險，請依照指示處理廢棄的電池